

# 0721-7 Series

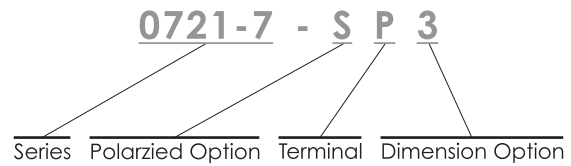

▶ Specification	▶ Inlet
<b>Power Rating</b>	2.5A 250V AC Europe & UL & CSA 7A 125V AC UL
<b>Electric Strength</b>	AC 2,000V for 1 Minute
<b>Contact Resistance</b>	30MΩ Max.
<b>Insulation Resistance</b>	100MΩ Min. at 500V DC
<b>Operating Temperature</b>	+85°C
<b>Materials</b>	Thermoplastic UL Flammability 94V-0 & Copper Alloy
<b>Polarized Option</b>	P : Non-Polarized S : Polarized
<b>Terminal</b>	P : PCB Pin
<b>Dimension Option</b>	2 : View A 3 : View B

Unit : mm

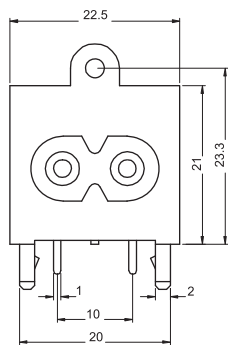

VIEW "A"

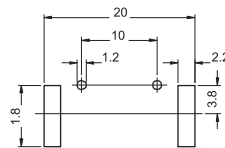
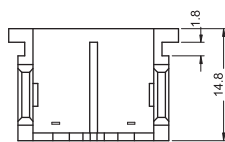

PCB LAYOUT

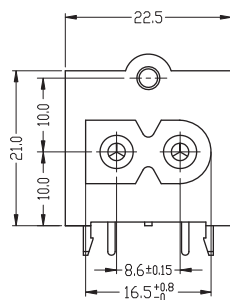

VIEW "B"

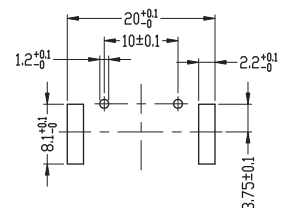
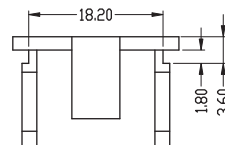

PCB LAYOUT